

MARINE PRODUCT DATA SHEET

OEM: 5901-0201 (Smart Sensor 5.7)

AFTERMARKET: 5901-0211 (Smart Sensor 5.7)

APPLICATION

Multi-fixture marine fresh water installations. Other uses may include 12V DC pressurized water systems in cabins. This pump may be used for general fresh water transfer.



PUMP:

Type: 5 Chamber Diaphragm
Ports: Quick Connect Fittings
Liquid: 130 °F [54 °C] Max
Dry-Prime: 6 feet [1.82 M]
Inlet PSI: 30 PSI [2.1 Bar] Max
Run Dry: Yes

ELECTRICAL:

Motor: 12VDC Permanent Magnet, Intermittent Duty
Protection: Thermal Overload, Automatic Restart
Leads: 14 AWG, 16" [40 cm] Red +, 13" [33 cm] Black -
Fuse: 15 Amp Recommended
Control: Microprocessor PWM Pressure Switch
Shut-Off: Voltage Variant, Factory Set at 65 PSI [4.4 Bar] @ 12V DC \pm 5 PSI [0.4 Bar]

MATERIALS:

Housing: Nylon
Valves: EPDM
Diaphragm: Santoprene
Hardware: Stainless Steel

APPROVALS:

Ignition Protection 8846, CE

WARRANTY:

3 Year Limited Warranty.
Contact SHURflo for details

SHIPPING:

Net Weight (boxed): 8.5 Lbs [3.9 Kg] each
Carton Quantity: 6
Carton Weight: 51 Lb [24 Kg]
Approx. Carton Size: 25"L x 19"W x 8"H
[63cm x 49.1cm x 21cm]

RELATED DOCUMENTS:

Catalog: MS-030-140
Installation Manual: 911-621
Applications Spec Guide: MS-020-005



The Smart Sensor 5.7 is designed specifically for cruisers and midsize yachts. Delivering over 5 GPM and pressure up to 60 PSI, this micro-controller based variable speed pump precisely monitors your system's water pressure and adjusts the motor speed, eliminating the need for an accumulator tank.

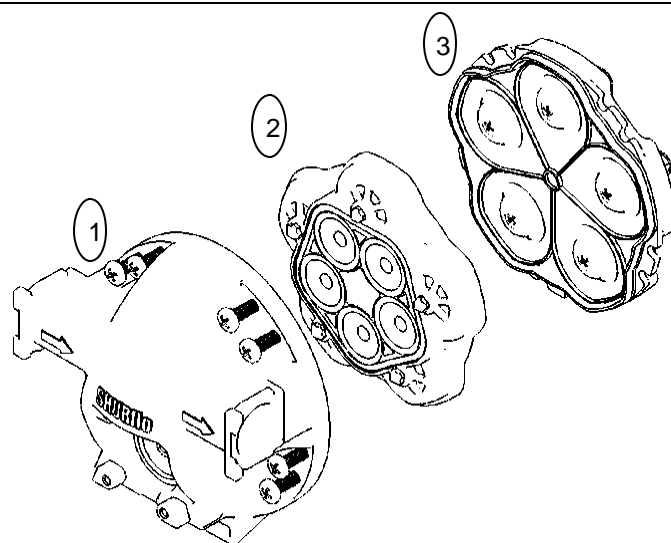

Repair Kits

| Number | Description | Part Number |
|--------|----------------|-------------|
| 1 | Upper Housing | 94-670-02 |
| 2 | Valve Assembly | 94-030-01 |
| 3 | Drive Assembly | 94-030-02 |

TYPICAL PERFORMANCE

| PRESSURE | | FLOW | | CURRENT |
|----------|-----|------|------|---------|
| BAR | PSI | GPM | LPM | AMPS |
| 0.0 | 0 | 5.5 | 20.8 | 5.0 |
| 0.7 | 10 | 4.0 | 15.1 | 9.0 |
| 1.4 | 20 | 3.0 | 11.3 | 9.6 |
| 2.1 | 30 | 2.5 | 9.46 | 9.4 |
| 3.5 | 50 | 1.5 | 5.67 | 10.3 |

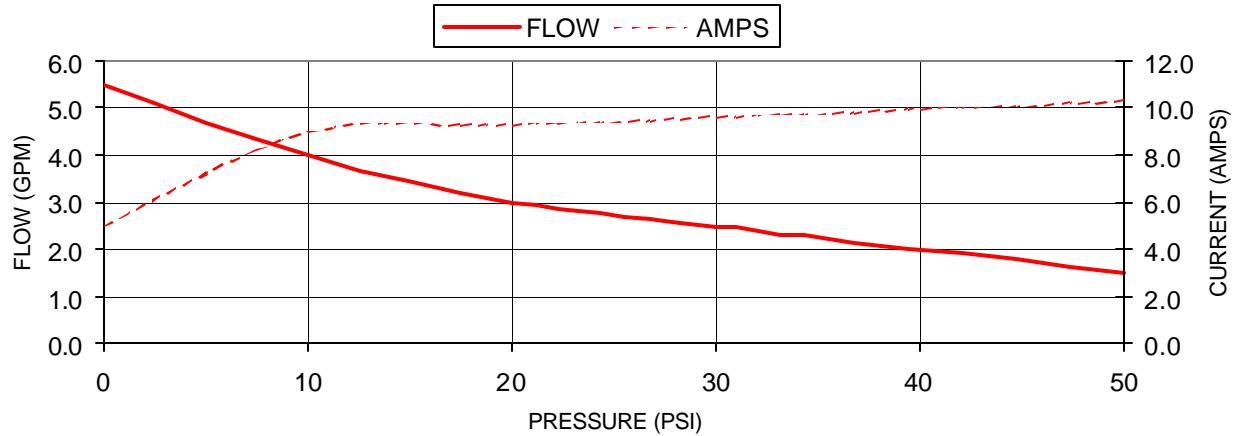

DIMENSIONS [mm]

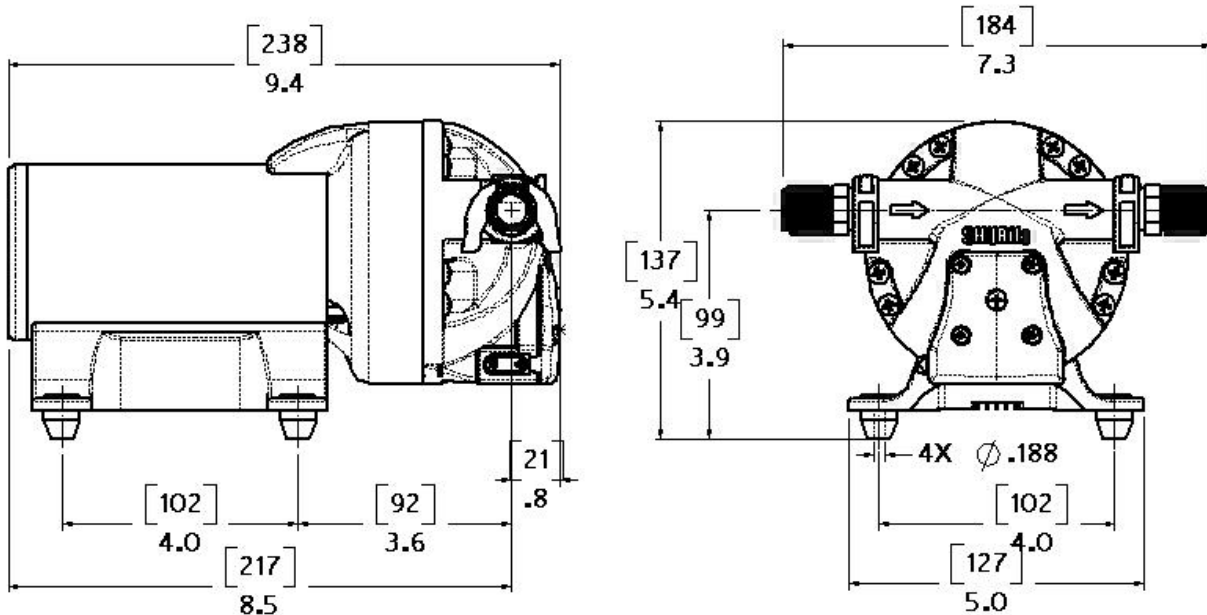

Visit our Web Site at <http://www.shurflo.com>
 Shurflo reserves the right to update specifications,
 change prices, or make substitutions without notice.

SHURflo
 5900 Katella Avenue
 Cypress, CA 90630
 Phone (562) 795-5200
 Toll Free (800) 854-3218
 Fax (562) 795-7564

SHURflo East
 52748 Park Six Court
 Elkhart, IN 46514-5427
 Phone (562) 795-5200
 Toll Free (800) 854-3218
 Fax (574) 264-2169

SHURflo Europe, Middle East, Africa
Pentair Water Belgium bvba
 Industriepark Wolfstee, Toekomstlann 30
 B-2200 Herentals, Belgium
 Phone +32-14-283500
 Fax +32-14-283505



Pentair Water

FLOW TECHNOLOGIES GROUP

5900 Katella Ave, Cypress, CA 90630
 Phone (800) 854-3218 • (562) 795-5200 • Fax (562) 795-7564
www.shurflo.com